



snatch blocks



Snatch block BL3 type

Groove size can be changed
on request for bigger rope sizes

Sheaves with bronze bearing
Sheaves with roller bearing on request

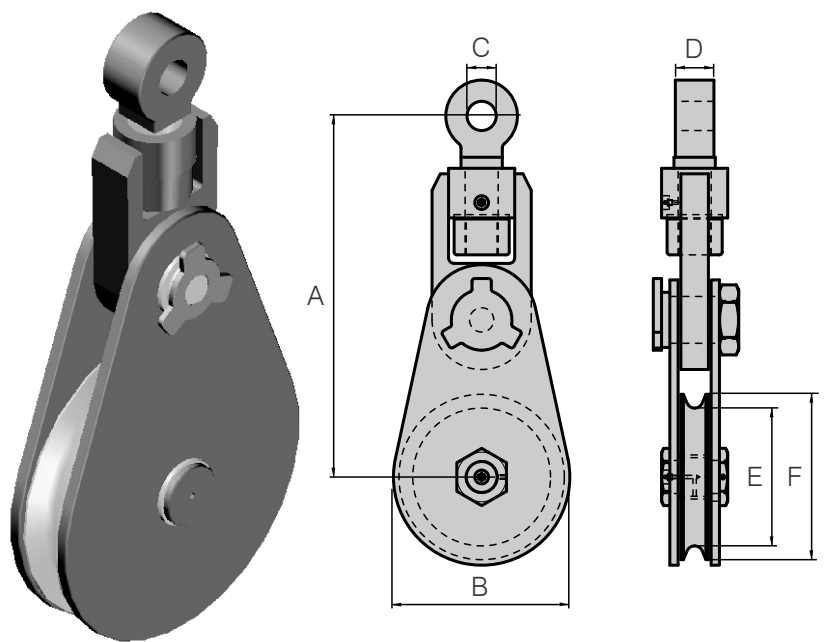

Working load limit	Rope size	A	B	C	D	E	F	Weight
[t]	[mm]	[t]	[mm]	[mm]	[mm]	[t]	[t]	[kg]

light duty

3.25	8 - 10	188	82	20	26	56	76	4.0
4.75	11 - 14	250	122	24	30	86	114	9.0
8.50	18 - 20	356	162	30	40	112	152	19.0
8.50	18 - 20	381	216	30	40	163	203	24.0
9.50	18 - 20	406	270	34	44	214	254	30.0
9.50	18 - 20	446	320	34	44	265	305	39.0
12.00	18 - 20	516	396	37	48	315	365	50.0
13.50	22 - 25	645	430	42	54	356	406	93.0
17.00	22 - 25	690	490	44	57	408	458	112.0

heavy duty

17.00	22 - 25	490	160	44	57	110	150	49.0
25.00	25 - 28	602	220	53	70	150	200	78.0
25.00	28 - 32	632	270	53	70	190	250	92.0
25.00	28 - 32	662	320	53	70	240	300	112.0
25.00	28 - 32	692	370	53	70	290	350	127.0
35.00	32 - 38	835	470	60	80	380	450	213.0
35.00	32 - 38	865	520	60	80	430	500	243.0
35.00	32 - 38	925	625	60	80	535	605	308.0
55.00	38 - 42	1040	625	73	100	520	605	449.0
85.00	44 - 48	1212	780	85	120	630	750	938.0
120.00	50 - 55	1327	880	100	140	740	860	1319.0
150.00	60 - 70	1427	930	113	160	760	910	1600.0
200.00	75 - 85	1630	1080	135	170	870	1060	2285.0
250.00	88 - 93	1785	1190	145	190	970	1170	3015.0

Factor of safety 4:1

Wire rope snatch block

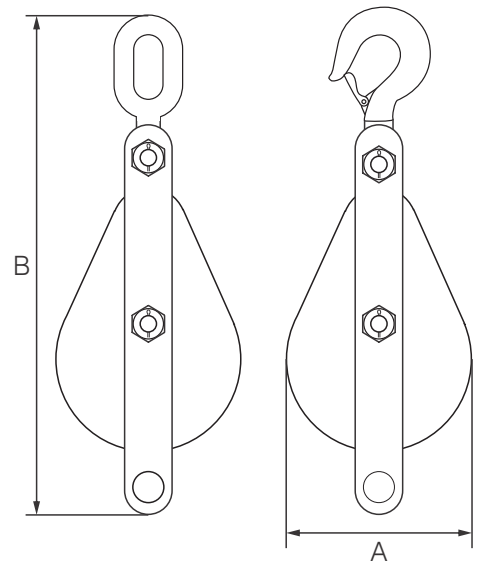

Working load limit	Sheave diameter	Rope diameter	A	B	Weight
[kg]	[mm]	[mm]	[mm]	[mm]	[kg]
500	100	10 - 13	110	300	3.0
1000	125	10 - 13	135	390	5.0
2000	150	10 - 13	165	460	7.0
3000	200	13 - 16	210	570	19.0
5000	250	16 - 20	265	700	32.0
7500	300	16 - 20	320	800	40.0
10000	350	20 - 22	370	900	70.0

Factor of safety 4:1



CAPE TOWN (HEAD OFFICE) +27 21 531 0525 JOHANNESBURG +27 11 826 3665
 NELSPRUIT +27 13 757 0334 DURBAN +27 31 205 8071 PEMBA +258 272 20 294



sales@anchor-industries.com
 www.anchor-industries.com